

ASSEMBLY AND INSTALLATION INSTRUCTIONS

BED RAT® Sliding Platform Model • 3100 • 3200 • 3300 • 3400

IMPORTANT BEFORE YOU BEGIN

Read these instructions and warnings completely before installing.

! WARNING

These instructions are to be followed for proper installation of this product. Improper installation or any modifications made to this product, could create a hazardous condition that can cause serious personal injury or property damage.

Approximate Assembly and Installation time:
5 hours per unit (5.0 hrs.)
Depending on Van equipment
installation experience.

- Load Rating -
750 lbs.
evenly distributed

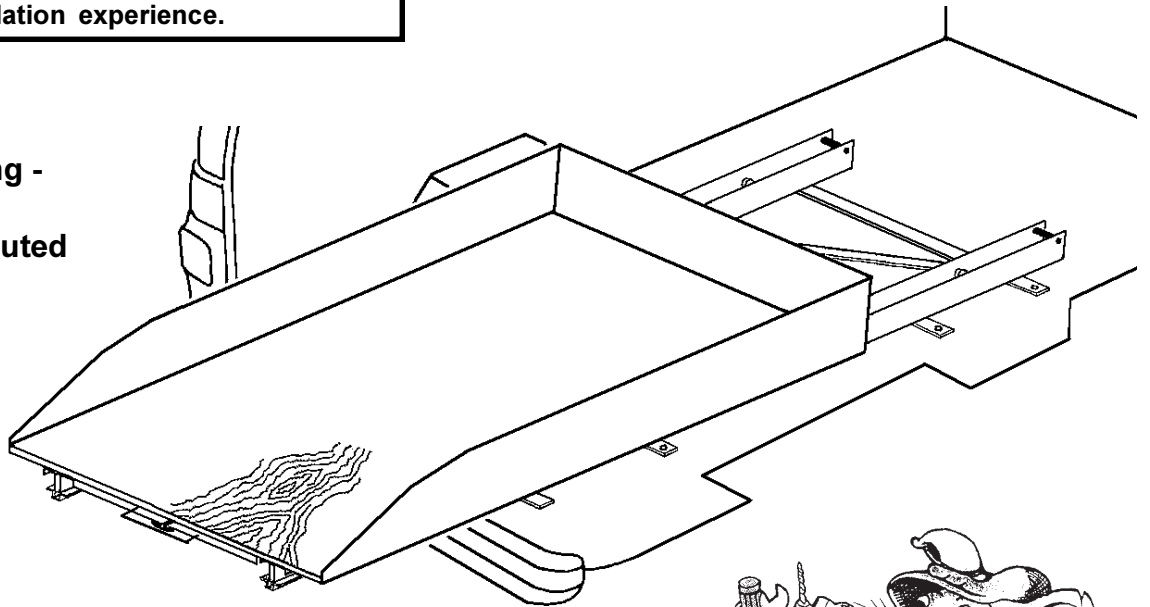

TOOLS REQUIRED

- Electric Drill
- 3/16", 5/16", 3/8" and 1/2" Drill Bits
- 1/2" Open or Box End Wrench
- 7/16" Open or Box End Wrench (2)
- 9/16" Open or Box End Wrench



BED RAT®

weather guard®

DIVISION OF KNAACK MFG. CO.

BOLT KITS - The following are provided with each model:

Model	3100 3200	3300 3400	Description
Bolt Kit	32-3200	32-3400	
	8	12	5/16-18 x 1-1/2" Bolt, Hex
	22	22	5/16-18 x 1-1/4" Carriage Bolt
	4	4	1/4-20 x 5/8" Bolt, Hex
	4	4	1/4-20 Whiz Nut
	12	16	5/16" Flat Washer
	8	12	5/16-18 Blind Fastener
	1	1	5/16-18 x 2-1/4" Blk. Ox. Bolt
	8	12	5/16 Lock Washer
	22	22	5/16-18 Whiz Nut
	1	1	Installation Tool
	2	2	3/8 x 4 Stop Pin
	4	4	5/16-18 Nylon Lock Nut
	4	0	Spacers

PARTS LIST

- 1 Deck Assembly
- 1 Base Assembly
- 1 Left End Retainer
- 1 Right End Retainer
- 1 Left Side Retainer
- 1 Right Side Retainer

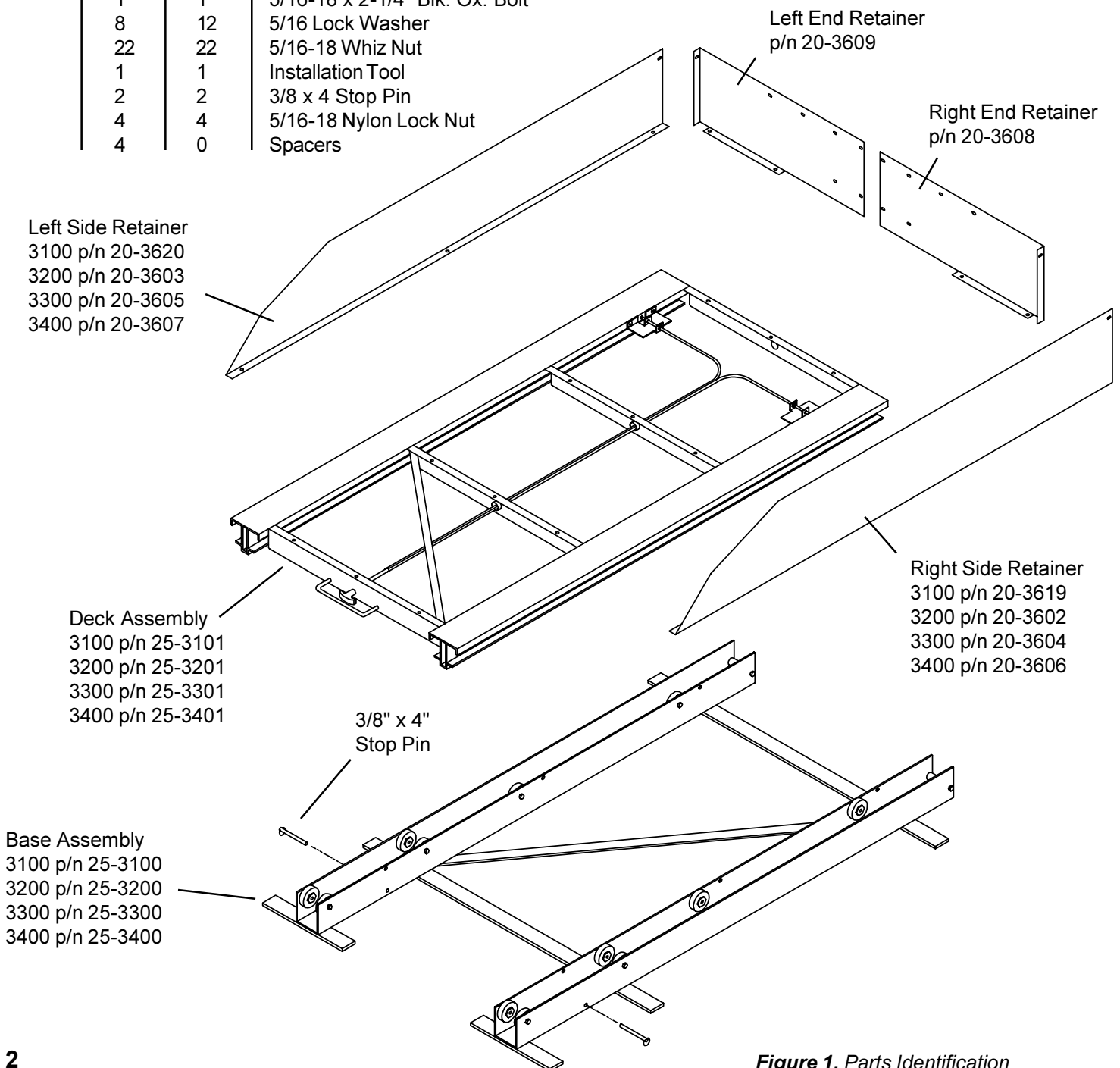

Figure 1. Parts Identification

**ASSEMBLY INSTRUCTIONS for
Models • 3200 • 3300 • 3400
(see back page for Model 3100)**

NOTE: To prevent rust from occurring, touch-up any drilled holes.

1. Place the Base Assembly centered in the vehicle. See *Figure 1.* for correct location. Close the tailgate or doors to make sure the unit is properly placed. If installing a Model 3100 out a van side door(s), make sure to take into account the door opening width. If installing a bulkhead, this should be done first.

2. Mark hole locations on the mounting bars, centering the holes on the bars and on the top portion of the floor ribs if possible. If it is not possible, four Spacers have been provided to fill the space between the mounting bars and the lower part of the floor ribs. NOTE: Twelve holes are required for Models 3300 & 3400, eight holes for Model 3200 (see *Figure 2.* for mounting holes) and four for Model 3100 (see *Figure 3.*). Drill through the mounting bar and the floor at one rear location, and insert a 5/16-18 x 1-1/2" Hex Hd. Bolt into the hole. Drill one front mounting bar location, and insert a bolt. Drill the rest of the mounting bar/floor holes.

⚠ CAUTION

To keep debris out of your eyes when checking the underside of the vehicle, or when drilling, always wear protective eyewear.

⚠ WARNING

All floor mounting bolts near the gas tank area should be installed from the underside of the vehicle, to guard against the gas tank being punctured in the event of a collision. This would mean not using Blind Fastener in this area. Holes drilled in this area should be 3/8".

⚠ WARNING

Prior to drilling, so as not to cut or puncture fuel tanks, fuel lines, brake lines, electrical lines, etc., check under vehicle for locations.

3. Remove the Base Assembly and re-drill the floor holes using a 1/2" drill bit.

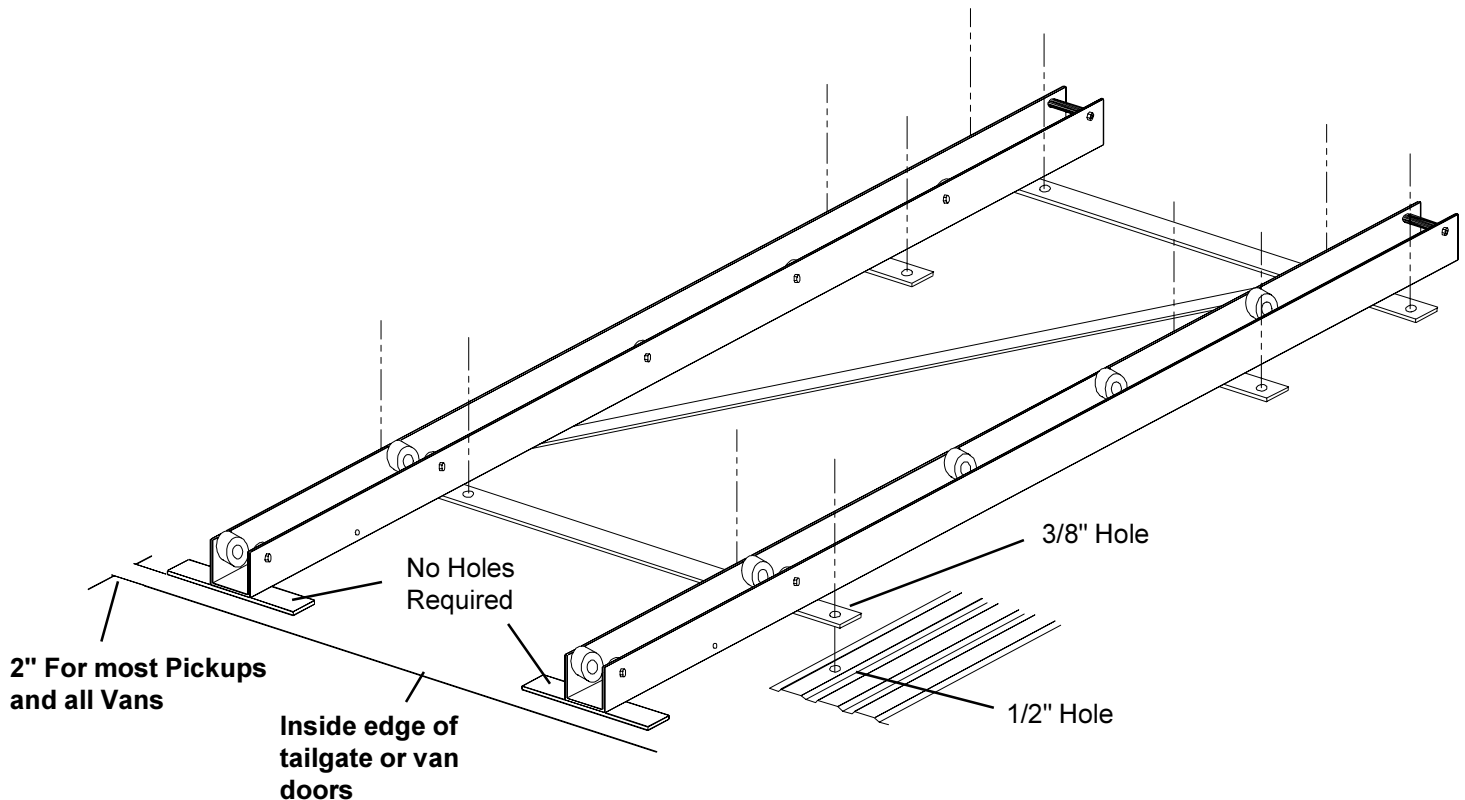

Figure 2. Base Assembly marking/drilling (Model 3400 shown)

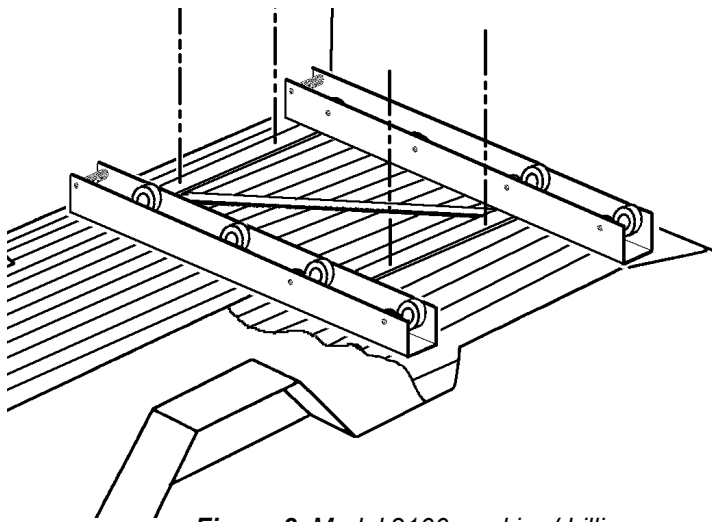

Figure 3. Model 3100 marking/drilling

4. Install Blind Fastener in the floor holes. See the Blind Fastener installation instructions on the back page. Replace the Base Assembly in the vehicle and fasten it to the floor (see Figure 4.).

5. To determine the size of the deck for pickups, the width must clear between the wheel wells, and the length must be just short of the inside length of the bed with the tailgate closed. For vans, the width must clear not only the wheel wells, but also any shelving or cabinetry fastened to the sides of the van and fit out the rear doors. The length must be just short of the inside length of the load area with the doors closed. In either case, the size of the deck may be considerably wider than the width of the bed rails, depending on the space available. We suggest using 3/4" plywood that is 2" less than the inside length of the pickup bed. In full size vans, the width should be 1" less than the inside dimension of the rear doors when fully open.

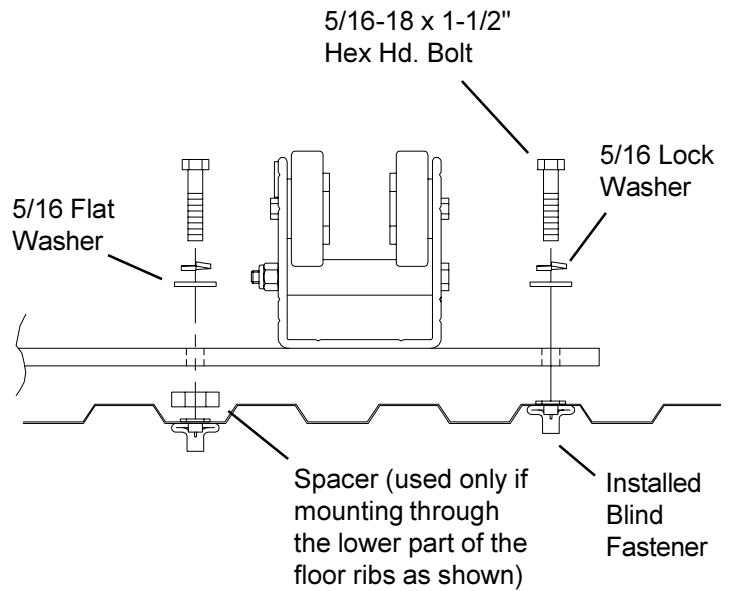

Figure 4. Fastening

6. Lay the decking material across two sawhorses. With the help of another person, place the Deck Assembly upside down on the deck material, 1" from the rear edge, and centered side to side. Using the Deck Assembly mounting angle holes as a drilling template, drill 5/16" holes through the deck material. Bolt the Deck Assembly to decking material (see Figure 5.).

5/16-18 Whiz Lock Nut
(12 places)
(6 places Model 3100)

Mounting
Angles

5/16-18 x 1-1/4"
Carriage Bolt
(12 places)
(6 places Model 3100)

Plywood should
extend 1" past
upper unit.

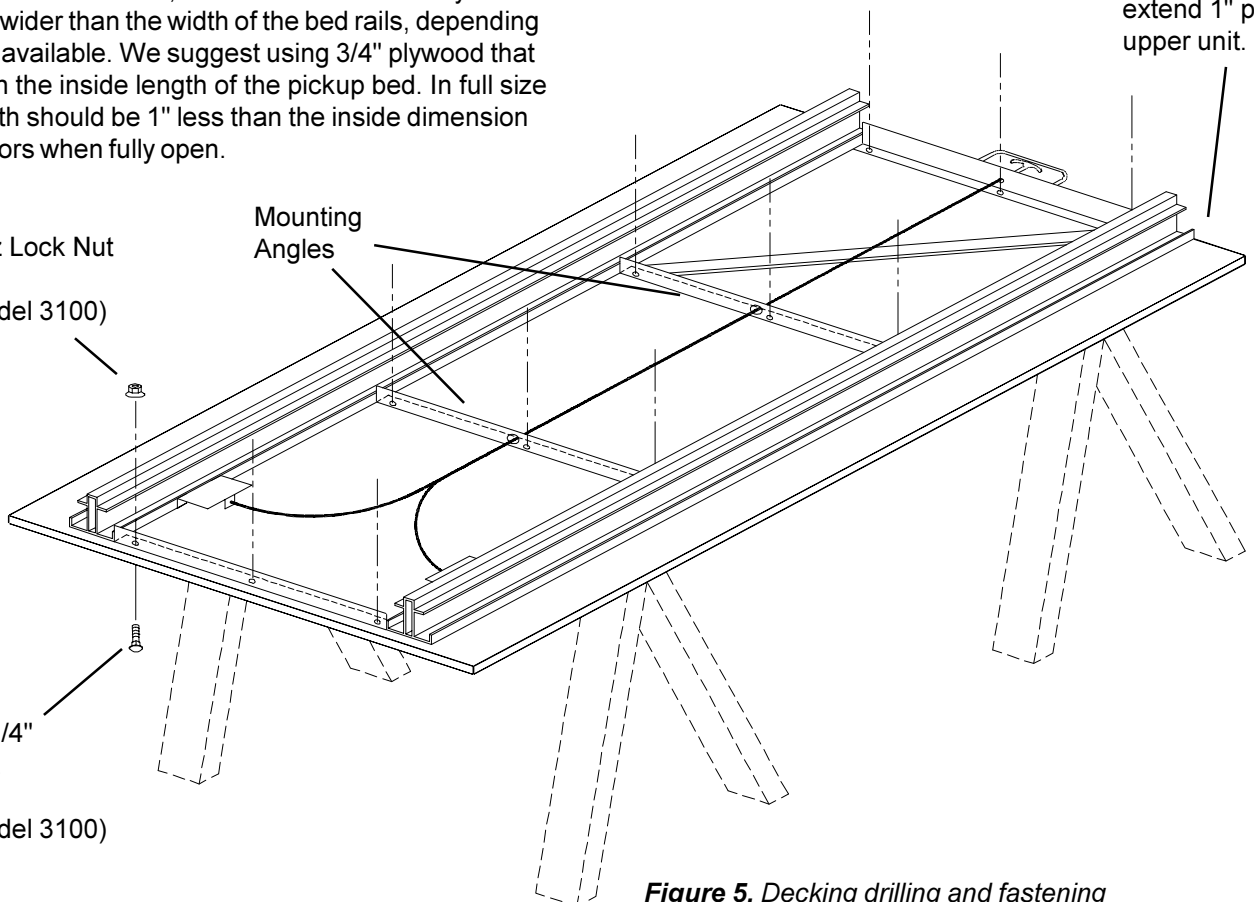

Figure 5. Decking drilling and fastening

7. With the Deck Assembly fastened to the decking material and still upside down, place a Side Retainer lip on the decking, flush with the front of the decking. Mark the Side Retainer mounting holes. Repeat this for the other Side Retainer. Place a Front Retainer on the decking at the front, with the flange butted up to the decking side. Mark the Front Retainer mounting holes. Repeat this for the other Front Retainer. Drill all marks with a 5/16" drill bit. Bolt the Side and Front Retainers to the Deck Assembly. Bolt the Side and Front Retainers together at the corners. The Front Retainers have slotted holes at the center that will align to bolt them together if using a decking with a width of 28", 30", 32", 35", 39", 40", 44" or 48". If using a decking with a non-standard width, it will be necessary to drill a set of 5/16" holes to fasten the Front Retainers together. Bolt the Front Retainers together (see Figure 6.).

8. With the help of another person, upright the Deck Assembly and slide it into the Base Assembly while holding the black release handle out. Install the two 3/8" x 4" Safety Stop Pins in the Base Assembly (see Figure 1.).

⚠ CAUTION

Both safety stop pins must be installed in the lower base to keep the upper deck unit from rolling off the lower base unit, which could result in serious personal injury or property damage.

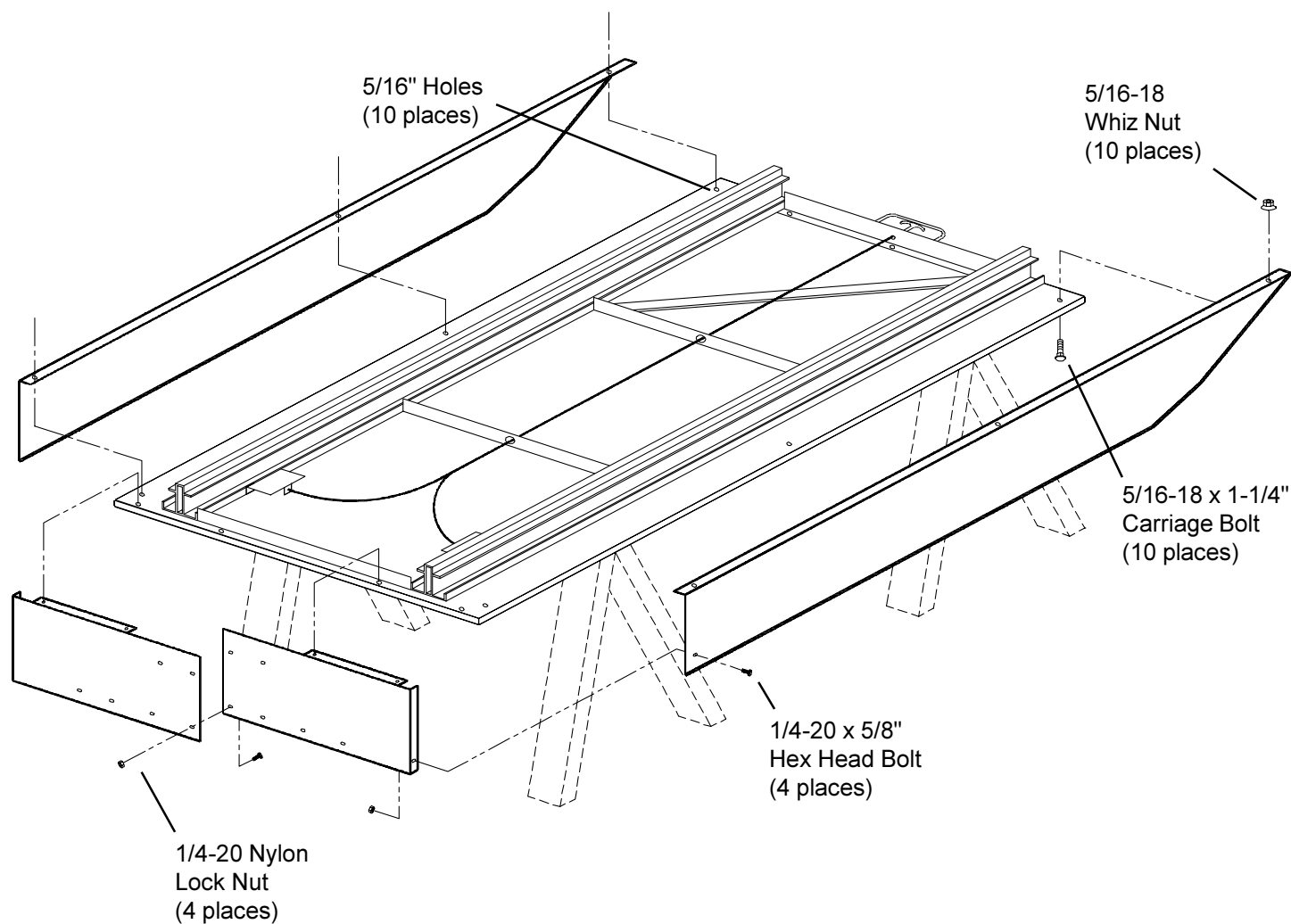

Figure 6. Side and End Retainer drilling and fastening

INSTALLATION PROCEDURE USING BLIND FASTENERS

⚠ WARNING

Prior to drilling, so as not to cut or puncture fuel tanks, fuel lines, brake lines, electrical wires, etc., check under vehicle for locations.

Place a drop of oil on the black oxide bolt before assembling as shown on right. Place the Blind Fastener in the hole and use a 1/2" or 7/16" wrench to tighten black hex bolt until the blind fastener is fully seated. When setting black hex bolt, it will start out hard. As the Blind Fastener "bulbs" out it will get easier, until it bottoms out or sets. Make sure the Blind Fastener and Installation Tool do not turn during installation.

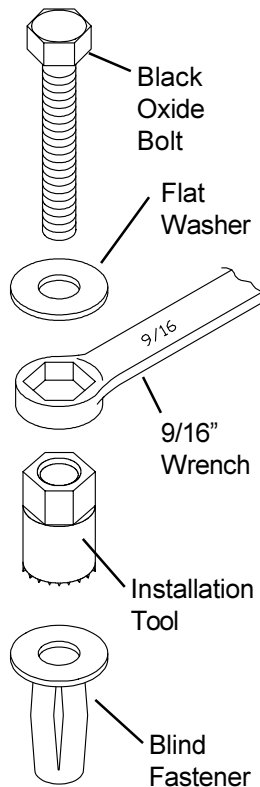

- NOTICE -

Any modification or unintended use of this product shall immediately void all manufacturers warranties. Manufacturer disclaims all liability for injuries to persons or property resulting from any modification to, or unintended use of this product.

If you have any questions, please give us a call. **Call Toll Free 1-800-456-7865**

WEATHER GUARD® products are protected by one or more of the following trademarks:

U.S. - 842268, 1661625, 1663369, 1840451, 1901674, 2228051, 2362167; Canada - 282725; U.K. - 1400720; N.Z. - 296049 other trademarks pending.

KNAACK
MANUFACTURING
COMPANY

KNAACK MANUFACTURING COMPANY

420 E. TERRA COTTA AVENUE
CRYSTAL LAKE, ILLINOIS, 60014 USA
815-459-6020

©2000 Knaack Manufacturing Company

